









LAYOUT NOTES

- Contractor responsible for field layout of all new improvements. Digital files of geometric information will be provided upon request in AutoCAD format. No additional payment will be made for adjustments necessary to construct the work as drawn.
- Contractor responsible to coordinate work in order to obtain approval of all layout by Owners Representative prior to construction. No additional payment will be made to correct work if constructed incorrectly without pre-approval by Owners Representative.
- Contractor responsible to maintain all layout stakes during construction. No additional payment will be made to replace layout stakes.
- Place stakes at edges of sport courts, fields, limits of playground, shelter, and every 25 feet on center along centerline of all pathways for review by the Owner's Representative prior to earthwork operations.
- All walls are dimensioned to Face of Wall unless otherwise noted.
- All dimensions from roadway are from Back of Curb unless otherwise noted.
- All curves and radii to be smooth and not segmented.
- Contractor to provide layout stakes every 10 feet minimum for large arcs where radius points are not accessible.
- Adjustment to stake locations due to discrepancies between coordinates and dimensions is incidental to the contract. No additional payments will be made for this work.
- All roadway widths are measured from edge of pavement to edge of pavement unless otherwise shown on the plans.
- Contractor responsible to take delivery, assemble and install all materials and furnishings per manufacturer's instructions.
- Place control and expansion joints as shown on plans and details for all curbs, walls, steps, and concrete paving. Where joints are not shown, place control joints a maximum of 10 feet on center, expansion joints a maximum of 30 feet on center, and between all separate pours.
- Contractor will maintain use zone requirements within soft surfacing; no use zone will overlap or be tangent unless noted. Adjust playground barrier curb and/or adjacent paving as needed to accommodate play equipment fall zones.
- Coordinate location of storm line with playground footings and obtain Owner's approval prior to installation.
- Layout of soft surface shall be verified in field by landscape architect.
- Refer to specifications for additional conditions, standards and notes.

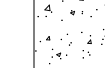
LAYOUT LEGEND

-  Expansion Joint
-  Asphalt Paving - Pedestrian
-  Asphalt Paving - Vehicular
-  Sport Court Paving
-  Concrete Paving
-  Playground Surfacing - Poured in Place Rubber Surfacing (Color A)
-  Playground Surfacing - Poured in Place Rubber Surfacing (Color B)
-  Designated Accessible Route

PLAY EQUIPMENT SCHEDULE

Code	Equipment	Structure Type
A	Sensory Wall	Landscape Structures
B	2-5 Play Structure	Landscape Structures
C	5-12 Play Structure	Landscape Structures
D	LSI Welcome Sign	Landscape Structures
E	Swings (2 belt, 2 full bucket, 1 ADA, 1 Friendship Swing)	Landscape Structures
F	Slidewinder 2	Landscape Structures

Construction Documents
April 23, 2024
REVISIONS

No	Date	Issue
	02/15/24	Addendum #1
2	02/26/24	Addendum #2

CHECKED BY: DNF
DRAWN BY: CAS

SHEET TITLE
Layout and Materials
Plan - Core Area
Enlargement

SCALE IN FEET
1" = 20'



NORTH SHEET NUMBER

L3.1

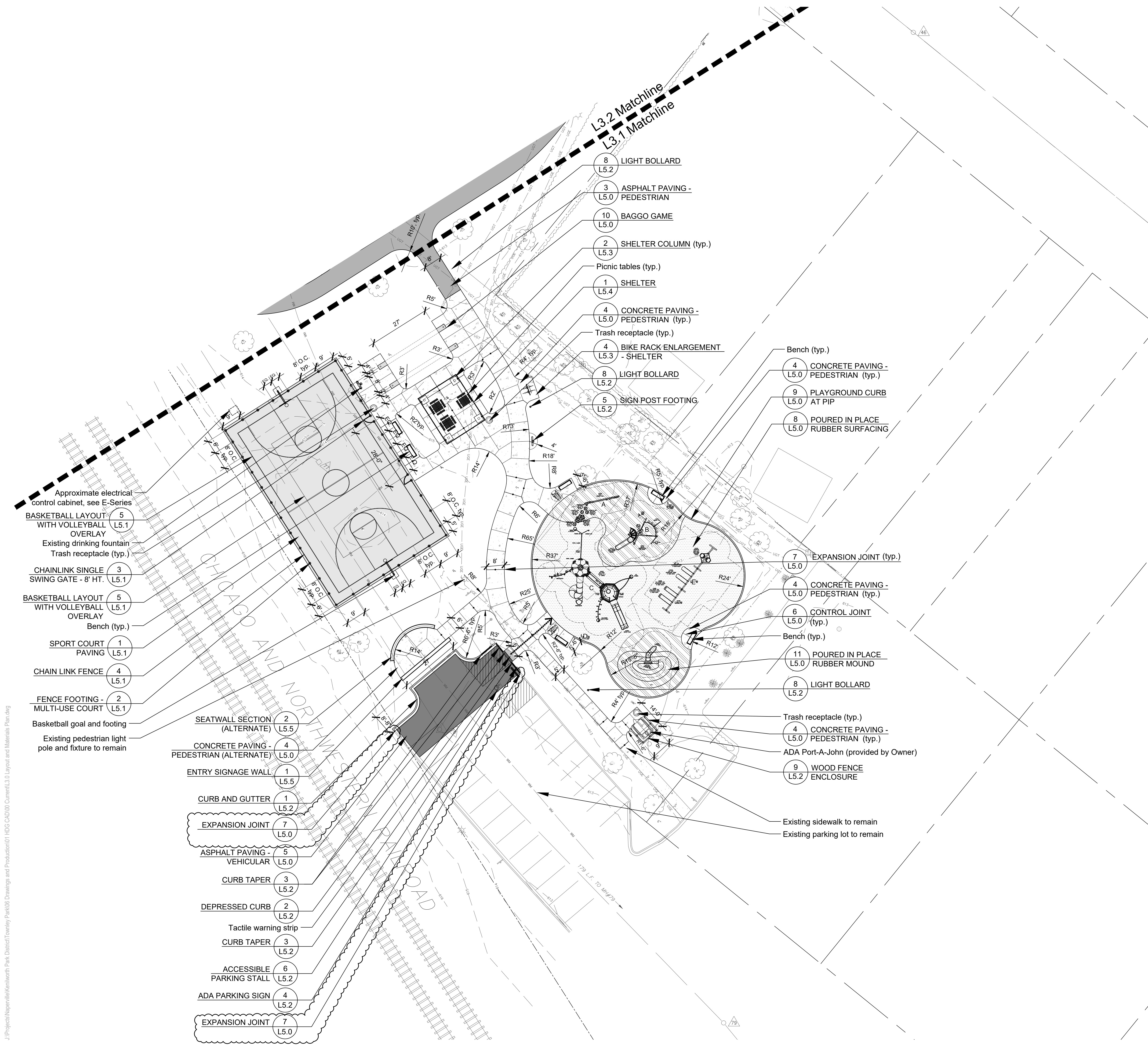

J:\Projects\Naperville\Kenilworth Park District\Townley Park\06 Drawings and Production\1 HDG CAD\00 Current\3.0 Layout and Materials Plan.dwg